

Campsite on the most beautiful lake of Sweden



Keep your
dog leashed!



WiFi Network : Viking Guest
Password : Viking12

Checking in & out



Opening hours reception:

- Daily 9:00 - 12:00 a.m. - 4:00 - 9:00 p.m.
- Check out Cabins before 11:00 a.m. Campsite before 3 p.m.

Visitors are required to register to the reception.

Price per day: 50 Sek. Overnight: 60 Sek

In the absence you can call +46 (0) 72 700 4003



Garbage

You can dispose your waste separately at the environmental station.
you will find it on the informationboard. Follow the signs and
recycle your waste.



colorless
glas



colored
glas



metal
packaging



cans / PET
bottles



wastewater
latrine



paper
packaging



plast
packaging



other
waste



Sanitary & Kitchen

In the yellow servicehouse you can use the kitchen and do the
laundry. You will also found the sanitary in this building.



toilet



toilet/
shower



shower



Drinking
water



disches



laundry



cooking



Bistro / Pub

Opening hours high season (25 june till 23 august)

- Pub is open every day 5:00 - 9:00 p.m.
- Kitchen is open from thursday till sunday 5:00 - 9:00 p.m.

Read our Corona/Covid19 guidelines carefully.

You will find this at the reception, the sanitary building and information board.

www.campviking.se



When checking out you can leave this folder at the reception.



Campsite on the most beautiful lake of Sweden



camp
viking



Reception / Information



Bistro Beacoup de Bia Bia



Sanitary



Waste



Waste water / Latrine



Canoe / Boat rental



Sauna



Fireplace



Fish Cleaning



Power Pole

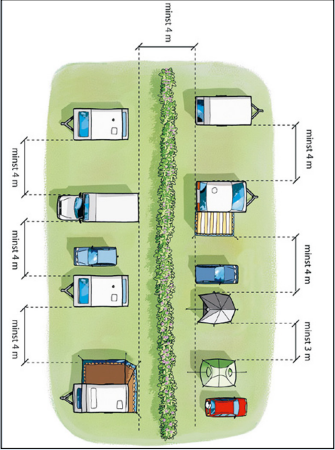
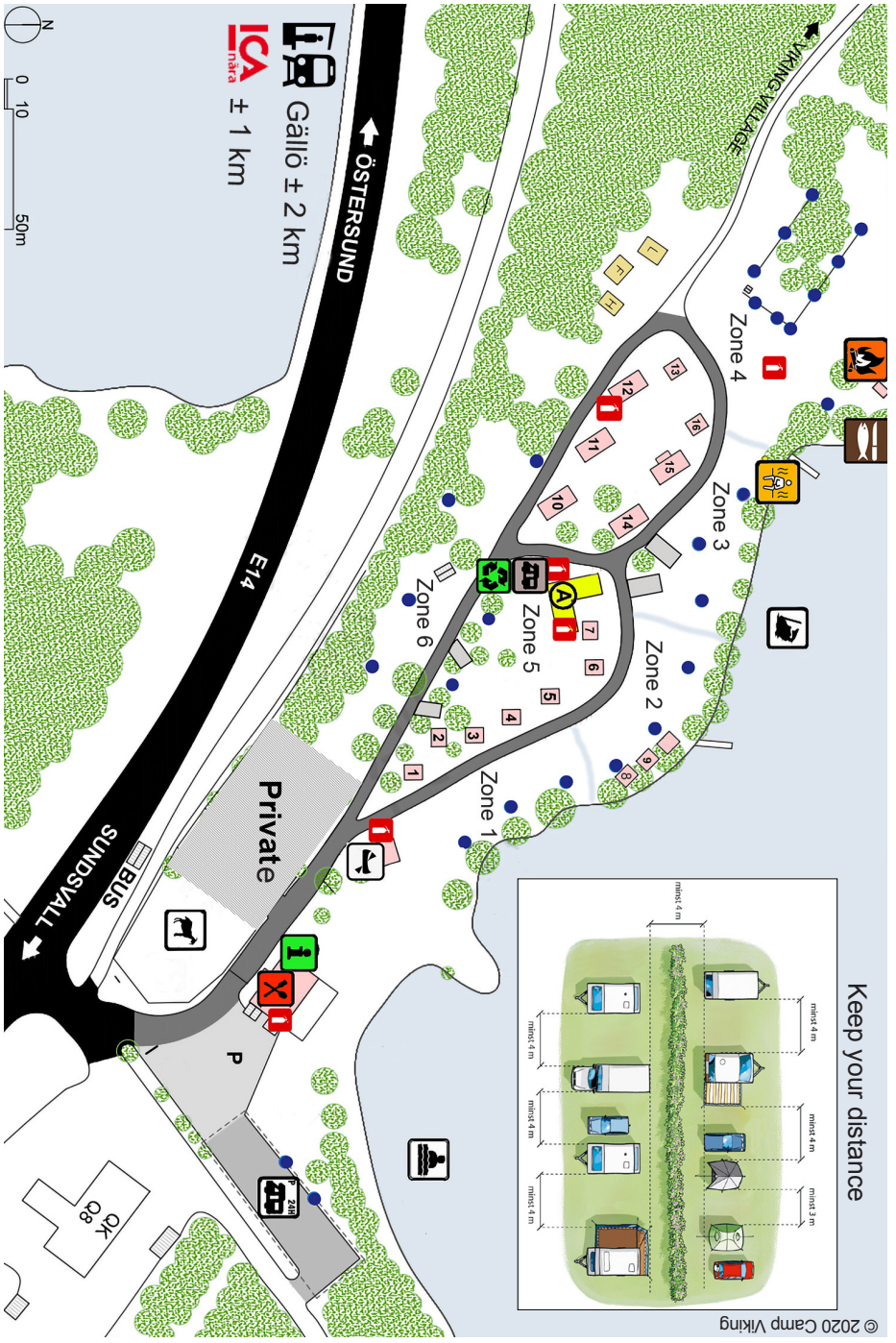

Keep your distance